



# ELECTRIC WIRE ROPE HOIST



ELECTRIC WIRE ROPE HOIST

### AC Brake

New design of AC brake electromagnetic motor disc system works precisely and synchronously with motors.

### MOTOR

Highly efficiently squirrel cage motors of 40%ED rate (40/20% for dual speed) are quiet, small volume, light weight and suitable for most applications.

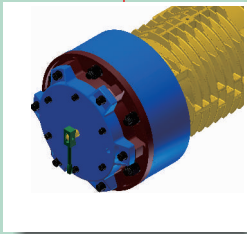

( Optional function )  
A 60%ED rate motor with cooling fan is available for heavy duty condition.

### Hook

Hot forged hooks with thrust bearing are enable to be swiveled 360°

### Control box

IP-20 control box is applied; Higher IP degree is available upon request.

### Gear box

Hoist reduction gear system are made of alloy steel with surface harden treatment for long lasting life span.

### Wire rope

According to JIS no.6 standard for wire rope applications, we use 6x37-A and IWRC 6xFi (29)-B wire rope which features flexible and long life span.

### Sheave

The proper diameter of sheave ensures the operation and life span of wire rope.

## PRODUCT CODE

**T**

### Model

T : MONORAIL TROLLEY  
S : SADDLE TROLLEY  
F : FOOTMOUNT

**B**

### Gear box

P : 2.2kw x 4P  
K : 3kw x 4P  
G : 5kw x 4P  
B : 7.5~11kw x 4P  
CA : 11~13kw x 4P  
EA : 13kw x 4P  
FA : 18.5kw x 4P

**H**

### Reeving/Falling

N:1/1 H:2/4  
M:1/2 I:2/6  
L:1/4 J:2/8  
P:1/6 K:2/10

**D**

Blank:single speed

D : Only hoist dual speed  
D1 : Only trolley dual speed  
D2 : Both hoist & trolley dual speed

**500**

### S.W.L.

100 : 1ton  
200 : 2ton  
300 : 3ton  
500 : 5ton  
750 : 7.5ton  
1000 : 10ton  
1500 : 15ton  
2000 : 20ton  
3000 : 30ton



# SB.SC.SE series

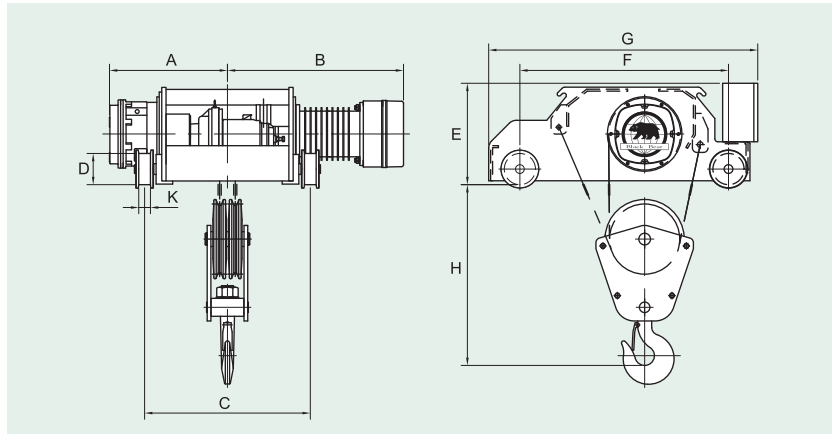

## SPECIFICATIONS & DIMENSIONS :

Model	Capacity (ton)	Lift (m)	Hoisting				Traversing				Wire Rope		Approximate Dimension (mm)										Approximate Weight (kg)					
			Speed (m/min)		Motor kw pole		ED %		Speed (m/min)		Motor kw pole		ED %		§ mm	R/F	H	A	B		C	D		E		F	G	K
		60Hz	50Hz	Single	Dual	Single	Dual	Single	Dual	Single	Dual	Single	Dual	Single	Dual	Single	Dual	Single	Dual	Single	Dual	Single	Dual	Single	Dual	Single	Dual	
SBH-500	5	6	7.3	6.1	7.5	4P	40	40/20	21	18	0.75	4P	40	40/20	§ 10	2/4	750	553	776	996	850	150	545	545	690	988	45	680
		9	7.3/2.4	6.1/2.0	7.5/2.5	4/12P	40	40/20	21/7	18/6	0.75/0.25	4/12P	40	40/20	§ 10	2/4	750	603	826	996	850	150	545	545	690	988	45	690
		12	7.3/2.4	6.1/2.0	7.5/2.5	4/12P	40	40/20	21/7	18/6	0.75/0.25	4/12P	40	40/20	§ 10	2/4	750	743	966	1136	1150	150	545	545	690	988	45	720
SBH-750	7.5	6	7.3	6.1	1.1	4P	40	40/20	20	17	1.1	4P	40	40/20	§ 14	2/4	1200	608	921	1000	850	160	550	550	790	1095	60	880
		9	7.3/2.4	6.1/2.0	1.1/3.7	4/12P	40	40/20	20/6	17/6	1.1/0.37	4/12P	40	40/20	§ 14	2/4	1200	743	1056	1135	1150	160	550	550	790	1095	60	1050
		12	7.3/2.4	6.1/2.0	1.1/3.7	4/12P	40	40/20	20/6	17/6	1.1/0.37	4/12P	40	40/20	§ 14	2/4	1200	833	1146	1225	1300	160	550	550	790	1095	60	1250
SBL-1000	10	6	5.0	4.2	1.1	4P	40	40/20	15	13	1.1	4P	40	40/20	§ 16	1/4	1300	605	903	982	850	160	570	570	970	1280	60	1070
		9	5.0/1.7	4.2/1.4	1.1/3.7	4/12P	40	40/20	15/5	13/4	1.1/0.37	4/12P	40	40/20	§ 16	1/4	1300	673	971	1050	1150	160	570	570	970	1280	60	1080
		12	5.0/1.7	4.2/1.4	1.1/3.7	4/12P	40	40/20	15/5	13/4	1.1/0.37	4/12P	40	40/20	§ 16	1/4	1300	773	1071	1150	1150	160	570	570	970	1280	60	1210
SCAH-1000	10	6	5.1	4.3	1.1	4P	40	40/20	17	14	1.1	4P	40	40/20	§ 16	2/4	1500	702	903	982	850	180	580	580	920	1250	60	1290
		9	5.1/1.7	4.3/1.4	1.1/3.7	4/12P	40	40/20	17/6	14/5	1.1/0.37	4/12P	40	40/20	§ 16	2/4	1500	817	1018	1097	1150	180	580	580	920	1250	60	1430
		12	5.1/1.7	4.3/1.4	1.1/3.7	4/12P	40	40/20	17/6	14/5	1.1/0.37	4/12P	40	40/20	§ 16	2/4	1500	914	1115	1194	1300	180	580	580	920	1250	60	1590
SEAL-1500	15	8	4.4	3.7	1.5	4P	40	40/20	18	15	1.5	4P	40	40/20	§ 20	1/4	1550	690	1040	1040	1150	200	715	715	1160	1500	60	1550
		10	4.4/1.5	3.7/1.2	1.5/0.5	4/12P	40	40/20	18/6	15/5	1.5/0.5	4/12P	40	40/20	§ 20	1/4	1550	735	1086	1086	1150	200	715	715	1160	1500	60	1765
		12	4.4/1.5	3.7/1.2	1.5/0.5	4/12P	40	40/20	18/6	15/5	1.5/0.5	4/12P	40	40/20	§ 20	1/4	1550	801	1152	1152	1300	200	715	715	1160	1500	60	2000
SCAL-2000	20	8	3.2	2.7	1.5	4P	40	40/20	18	15	1.5	4P	40	40/20	§ 20	1/4	1700	760	1040	1040	1150	200	715	715	1160	1500	60	1950
		10	3.2/1.1	2.7/0.9	1.5/0.5	4/12P	40	40/20	18/6	15/5	1.5/0.5	4/12P	40	40/20	§ 20	1/4	1700	806	1086	1086	1150	200	715	715	1160	1500	60	2080
		12	3.2/1.1	2.7/0.9	1.5/0.5	4/12P	40	40/20	18/6	15/5	1.5/0.5	4/12P	40	40/20	§ 20	1/4	1700	872	1152	1152	1300	200	715	715	1160	1500	60	2230

1.R/F=Reeving/falling numbers.

2.Dual speed model under green shadow.

3.Traversing pinion 5 ton M3.5x23t, 7.5 ton M3.5x20t, 10-20 ton M3.5x23t.

4.Traversing motor standard supply, 50 Hz or 60Hz all used 4 pole, or please specify.

5.Traversing motor: used reducing gear motor.

# SK.SG series

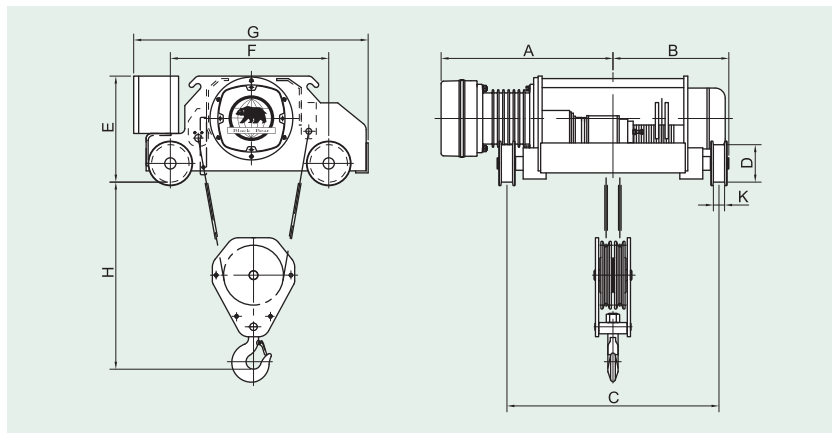

## SPECIFICATIONS & DIMENSIONS :

Model	Capacity (ton)	Lift (m)	Hoisting				Traversing				Wire Rope		Approximate Dimension (mm)										Approximate Weight (kg)					
			Speed (m/min)		Motor kw pole		ED %		Speed (m/min)		Motor kw pole		ED %		§ mm	R/F	H	A	B	C	D	E		F	G	K		
		60Hz	50Hz	Single	Dual	Single	Dual	Single	Dual	Single	Dual	Single	Dual	Single	Dual	Single	Dual	Single	Dual	Single	Dual	Single	Dual	Single	Dual	Single	Dual	
SKM-200	2	6	8	6.7	3	4P	40	40/20	20	17	0.25	4P	40	40/20	§ 10	1/2	600	680	680	401	600	120	390	460	615	923	40	420
		9	8/2.7	6.7/2.2	3/1	4P	40	40/20	20/6	17/6	0.25/0.08	4/12P	40	40/20	§ 10	1/2	600	680	680	401	600	120	390	460	615	923	40	440
		12	8/2.7	6.7/2.2	3/1	4P	40	40/20	20/6	17/6	0.25/0.08	4/12P	40	40/20	§ 10	1/2	600	732	732	462	850	120	390	460	615	923	40	450
SKH-200	2	6	8	6.7	3	4P	40	40/20	20	17	0.25	4P	40	40/20	§ 8	2/4	600	701	701	462	850	120	390	460	615	923	40	450
		9	8/2.7	6.7/2.2	3/1	4P	40	40/20	20/6	17/6	0.25/0.08	4/12P	40	40/20	§ 8	2/4	600	788	788	509	850	120	390	460	615	923	40	470
		12	8/2.7	6.7/2.2	3/1	4P	40	40/20	20/6	17/6	0.25/0.08	4/12P	40	40/20	§ 8	2/4	600	875	875	612	1150	120	390	460	615	923	40	490
SKL-300	3	6	4.4	3.7	3	4P	40	40/20	21	18	0.4	4P	40	40/20	§ 10	1/4	650	729	729	465	850	150	425	495	725	1030	45	500
		9	4.4/1.5	3.7/1.2	3/1	4P	40	40/20	21/7	18/6	0.4/0.13	4/12P	40	40/20	§ 10	1/4	650	802	802	523	850	150	425	495	725	1030	45	530
		12	4.4/1.5	3.7/1.2	3/1	4P	40	40/20	21/7	18/6	0.4/0.13	4/12P	40	40/20	§ 10	1/4	650	919	919	640	1150	150	425	495	725	1030	45	560
SGM-300	3	6	8	6.7	5	4P	40	40/20	21	18	0.4	4P	40	40/20	§ 12	1/2	750	702	814	477	850	150	495	495	660	968	45	490
		9	8/2.7	6.7/2.2	5/1.7	4/12P	40	40/20	21/7	18/6	0.4/0.13	4/12P	40	40/20	§ 12	1/2	750	702	814	477	850	150	495	495	660	968	45	500
		12	8/2.7	6.7/2.2	5/1.7	4/12P	40	40/20	21/7	18/6	0.4/0.13	4/12P	40	40/20	§ 12	1/2	750	804	916	579	850	150	495	495	660	968	45	510
SGH-300	3	6	8	6.7	5	4P	40	40/20	21	18	0.4	4P	40	40/20	§ 10	2/4	750	754	866	529	850	150	495	495	635	940	45	520
		9	8/2.7	6.7/2.2	5/1.7	4/12P	40	40/20	21/7	18/6	0.4/0.13	4/12P	40	40/20	§ 10	2/4	750	827	939	602	850	150	495	495	635	940	45	580
		12	8/2.7	6.7/2.2	5/1.7	4/12P	40	40/20	21/7	18/6	0.4/0.13	4/12P	40	40/20	§ 10	2/4	750	944	1056	719	1150	150	495	495	635	940	45	610
SGL-500	5	6	4.4	3.7	5	4P	40	40/20	21	18	0.75	4P	40	40/20	§ 10	1/4	700	754	866	529	850	150	495	545	725	1030	45	570
		9	4.4/1.5	3.7/1.2	5/1.7	4/12P	40	40/20	21/7	18/6	0.75/0.25	4/12P	40	40/20	§ 10	1/4	700	827	939	602	850	150	495	545	725	1030	45	590
		12	4.4/1.5	3.7/1.2	5/1.7	4/12P	40	40/20	21/7	18/6	0.75/0.25	4/12P	40	40/20	§ 10	1/4	700	944	1056	719	1150	150	495	545	725	1030	45	630

1.R/F=Reeving/falling numbers.

2.Dual speed model under green shadow.

3.Traversing pinion 2 ton M3.5x15t, 3-5 ton, M3.5x23t.

4.Traversing motor standard supply, 50 Hz or 60Hz all used 4 pole, or please specify.

5.Traversing motor: 2 ton used planetary reducing gear motor, 3-5 ton used reducing gear motor.

# SF SERIES

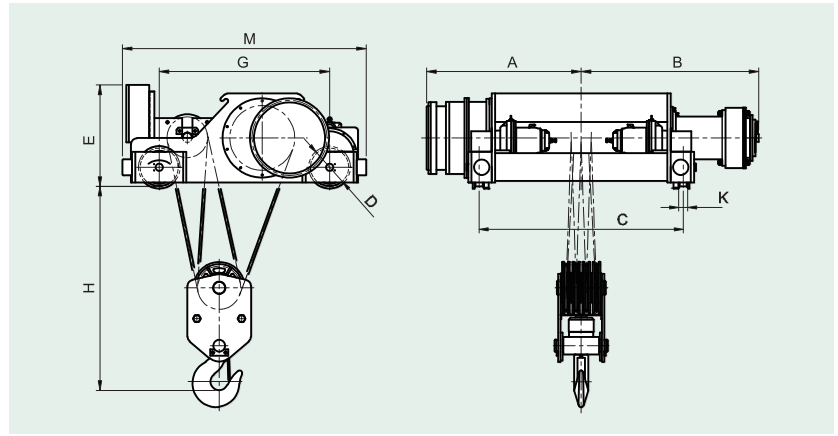
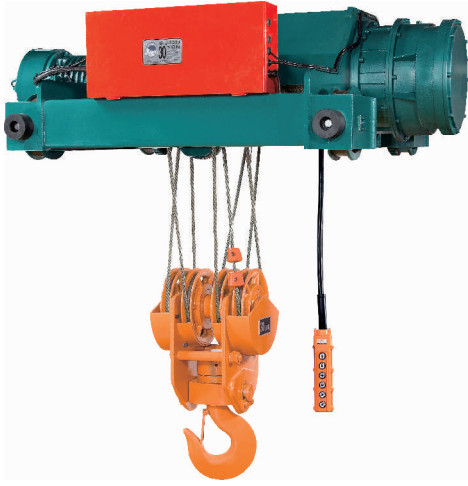

## SPECIFICATIONS & DIMENSIONS :

Model	Capacity (ton)	Lift (m)	Hoisting				Traversing				Wire Rope		Approximate Dimension (mm)										Approximate Weight (kg)		
			Speed (m/min) 60Hz	Speed (m/min) 50Hz	Motor kw pole	ED %	Speed (m/min) 60Hz	Speed (m/min) 50Hz	Motor kw pole	ED %	Single	Dual	φ mm	R/F	H	A	B		C	D	E	G		K	M
SFAH-1500	15	8	6.1	5.1	1.5/4P	40	40/20	18	15	1.5/4P	40	40/20	φ 18	2/4	1600	1007	1140	1235	1150	200	725	1150	60	1475	2115
		10	6.1/2.0	5.1/1.7	1.8/5/6.2/4/12P	40	40/20	18/6	15/5	1.5/0.5/4/12P	40	40/20	φ 18	2/4	1600	1053	1186	1281	1400	200	725	1150	60	1475	2351
		12														1093	1226	1321	1400						2528
SFAJ-3000	30	8	3.0	2.5	1.8/4P	40	40/20	21	17.5	1.5/2/4P	40	40/20	φ 18	2/8	1800	1113	1246	1343	1400	300	795	1336	70	1912	2500
		10	3.0/1.0	2.5/0.8	1.8/5/6.2/4/12P	40	40/20	21/7	17.5/5.8	1.5/0.5/2/4/12P	40	40/20	φ 18	2/8	1800	1213	1346	1443	1600	300	795	1336	70	1912	2725
		12														1313	1446	1543	1800						2950

1.R/F=Reeving/falling numbers.

2.Dual speed model under green shadow.

3.Traversing pinion M4x18t.

4.Traversing motor standard supply, 50 Hz or 60Hz all used 4 pole, or please specify.

5.Traversing motor: used reducing gear motor.

# FP.FK.FG.FB SERIES

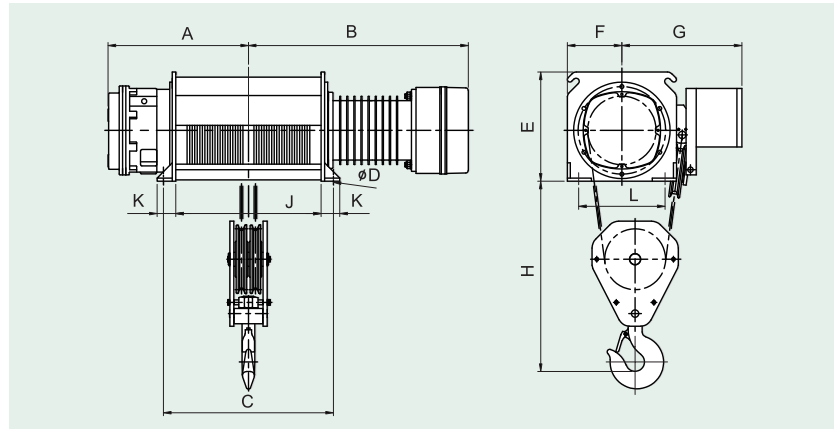
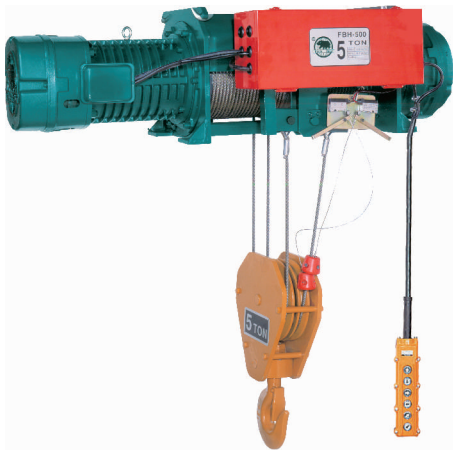

## SPECIFICATIONS & DIMENSIONS :

Model	Capacity (ton)	Lift (m)	Hoisting				Wire Rope		Approximate Dimension (mm)													Approximate Weight (kg)
			Speed (m/min) 60Hz	Speed (m/min) 50Hz	Motor kw pole	ED %	φ mm	R/F	H	A	B	C	D	E	F	G	J	K	L			
FPM-100	1	6	10.8	9	2.2/4P	40	φ 8	1/2	650	314	531	467	φ 16	310	150	450	373	72	280	205		
		9								364	581	567					473			215		
		12								414	631	667					573			225		
		15								464	681	767					673			235		
		6								348	627	466					372			319		
FKM-200	2	9	8	6.7	3/4P	40	φ 10	1/2	1150	401	680	571	φ 16	390	232	420	477	72	260	339		
		12								453	732	676					582			359		
		15								506	785	781					687			379		
		6								422	701	614					520			359		
		9								509	788	788					694			399		
FKH-200	2	12	8	6.7	3/4P	40	φ 8	2/4	1150	596	875	961	φ 16	390	232	433	867	72	260	439		
		15								682	961	1134					1040			479		
		6								435	660	482					384			330		
		9								477	702	565					467			350		
		12								579	804	770					672			370		
FGM-300(280)	3(2.8)	15	8	6.7	5/4P	40	φ 12	1/2	1250	634	829	880	φ 16	430	185	430	782	74	280	390		
		6								450	729	670					572			350		
		9								523	802	815					717			390		
		12								640	919	1049					951			430		
		15								733	1012	1235					1137			470		
FKL-300(280)	3(2.8)	6	4.4	3.7	3/4P	40	φ 10	1/4	1100	529	754	670	φ 16	360	275	443	572	74	310	330		
		9								602	827	815					717			365		
		12								719	944	1049					951			395		
		15								814	1039	1235					1141			425		
		6								529	754	670					572			413		
FGH-300(280)	3(2.8)	9	8	6.7	5/4P	40	φ 10	2/4	1250	602	827	815	φ 16	430	185	443	717	74	280	365		
		12								719	944	1049					951			395		
		15								814	1039	1235					1141			425		
		6								529	754	670					572			413		
		9								602	827	815					717			433		
FGL-500	5	12	4.4	3.7	5/4P	40	φ 10	1/4	1100	719	944	1049	φ 16	430	285	453	951	74	330	453		
		15								805	1114	1221					1123			473		
		6								553	776	670					572			483		
		9								603	826	770					672			523		
		12								743	966	1049					951			603		
FBH-500	5	15	7.3	6.1	7.5/4P	40	φ 10	2/4	1300	838	1061	1239	φ 16	440	215	483	1141	74	350	633		

1.R/F=Reeving/falling numbers.

# TP.TK.TG SERIES

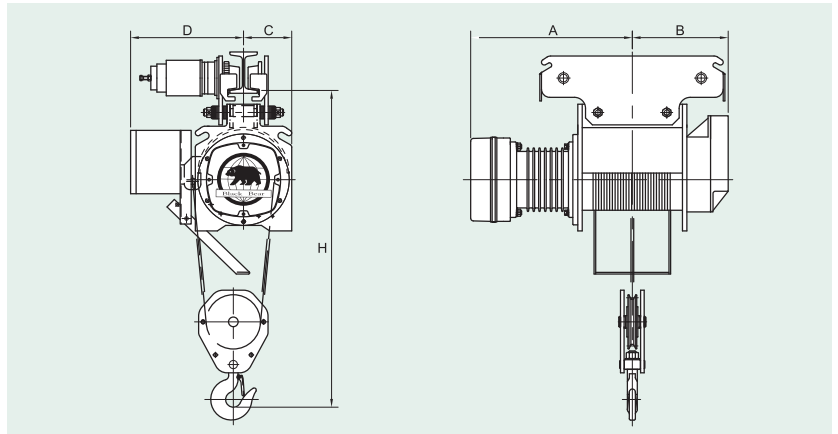
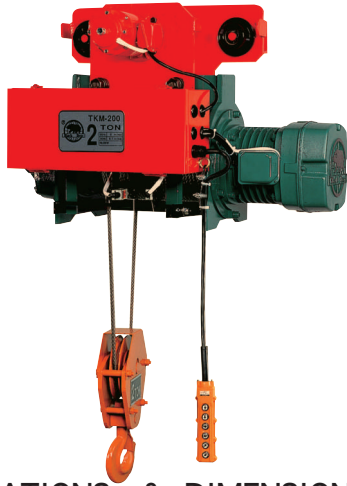

## SPECIFICATIONS & DIMENSIONS :

Model	Capacity (ton)	Lift (m)	Hoisting				Traversing				Wire Rope		Approximate Dimension (mm)								Approximate Weight (kg)					
			Speed (m/min)		Motor kw pole	ED %		Speed (m/min)		Motor kw pole	ED %		mm	R/F	H	A		B	C			D		Adjust for Std. I-Beam (mm)		
			60Hz	50Hz		Single	Dual	60Hz	50Hz		Single	Dual				Single	Dual	Single	Dual	Single	Dual					
TPM-100	1	6	10.8	9	2.2 4P	40	40/20	24	20	0.25 4P	40	40/20	§ 8	1/2	1050	530	611	314	210	210	380	380	75-125	246		
TPMD-100		9	10.8/3.6	9/3	2.2/0.73 4/12P			24/8	20/6	0.25/0.08 4/12P						246										
TKM-200		12	8	6.7	3 4P			24	20	0.25 4P						256										
TKMD-200	2	6	8	6.7	3 4P	40	40/20	24	20	0.25 4P	40	40/20	§ 10	1/2	1150	627	627	350	232	232	410	410	100-150	370		
TKH-200		9	8/2.7	6.7/2.2	3/1 4/12P			24/8	20/6	0.25/0.08 4/12P						390										
TKHD-200		12	8	6.7	3 4P			24	20	0.25 4P						410										
TKL-300	3	6	4.4	3.7	3 4P	40	40/20	18	15	0.6 4P	40	40/20	§ 10	1/4	1150	729	729	518	275	275	443	443	125-175	410		
TKLD-300		9	4.4/1.5	3.7/1.2	3/1 4/12P			18/6	15/5	0.6/0.2 4/12P						450										
TGM-300		12	8	6.7	5 4P			18	15	0.6 4P						490										
TGMD-300	3	6	8	6.7	5 4P	40	40/20	18	15	0.6 4P	40	40/20	§ 12	1/2	1200	702	814	477	185	210	430	455	125-175	410		
TGH-300		9	8/2.7	6.7/2.2	5/1.7 4/12P			18/6	15/5	0.6/0.2 4/12P						430										
TGHD-300		12	8	6.7	5 4P			18	15	0.6 4P						450										
TGL-500	5	6	4.4	3.7	5 4P	40	40/20	18	15	0.6 4P	40	40/20	§ 10	1/4	1200	754	866	564	185	210	443	468	125-175	410		
TGLD-500		9	4.4/1.5	3.7/1.2	5/1.7 4/12P			18/6	15/5	0.6/0.2 4/12P						425										
		12	8	6.7	5 4P			18	15	0.6 4P						455										
																944	1056	719							520	
																										540
																										560

1.R/F=Reeving/falling numbers.

2.Dual speed model under green shadow.

3.Traversing pinion 2 ton M3.5x16t, 3-5 ton M3.5x12t.

4.Traversing motor standard supply, 50 Hz or 60Hz all used 4 pole, or please specify.

# TB SERIES

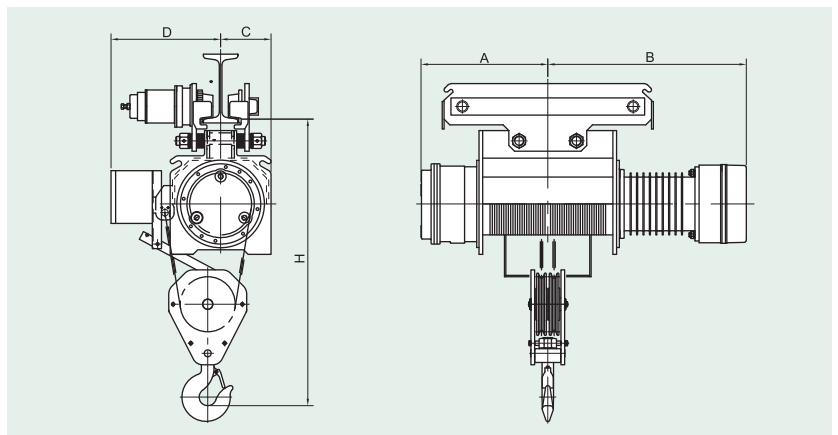

## SPECIFICATIONS & DIMENSIONS :

Model	Capacity (ton)	Lift (m)	Hoisting				Traversing				Wire Rope		Approximate Dimension (mm)								Approximate Weight (kg)			
			Speed (m/min)		Motor kw pole	ED %		Speed (m/min)		Motor kw pole	ED %		mm	R/F	H	A		B		C		D		Adjust for Std. I-Beam (mm)
			60Hz	50Hz		Single	Dual	60Hz	50Hz		Single	Dual				Single	Dual	Single	Dual	Single	Dual	Single	Dual	
TBH-500	5	6	7.3	6.1	7.5 4P	40	40/20	18	15	0.6 4P	40	40/20	§ 10	2/4	1250	553	776	946	220	255	488	513	125-175	590
TBHD-500		9	7.3/2.4	6.1/2.0	7.5/2.5 4/12P			18/6	15/5	0.6/0.2 4/12P						630								
TBH-750		12	7.3	6.1	11 4P			20	17	1.1 4P						608								
TBHD-750	7.5	6	7.3	6.1	11 4P	40	40/20	20	17	1.1 4P	40	40/20	§ 14	2/4	2000	743	1056	1135	240	240	612	612	150-200	990
TBL-1000		9	7.3/2.4	6.1/2.0	11/3.7 4/12P			20/6	17/6	1.1/0.37 4/12P						743								
TBLD-1000		12	7.3	6.1	11 4P			20	17	1.1 4P						833								
	10	6	5.0	4.2	11 4P	40	40/20	18	15	1.1 4P	40	40/20	§ 16	1/4	2000	605	903	982	340	340	640	725	150-200	970
		9	5.0/1.7	4.2/1.4	11/3.7 4/12P			18/6	15/5	1.1/0.37 4/12P						673								
		12	5.0/1.7	4.2/1.4	11/3.7 4/12P			18/6	15/5	0.75/0.25x2 4/12P						773								

1.R/F=Reeving/falling numbers.

2.Dual speed model under green shadow.

3.Traversing pinion 5 ton M3.5x12t, 7.5 ton M3.5x20t, 10 ton M3.5x23t.

4.Traversing motor standard supply, 50 Hz or 60Hz all used 4 pole, or please specify.

5.Traversing motor: 5 ton used planetary reducing gear motor, 7-10 ton used reducing gear motor.

# PRODUCT GUIDE

Capacity (ton)	Monorail High Speed	Crab High Speed	Footmount High Speed	Monorail Low Speed	Crab Low Speed	Footmount Low Speed	Dual Speed
1	TPM-100		FPM-100				TPMD-100
2	TKM-200	SKM-200	FKM-200				TKMD-200 SKMD-200
2	TKH-200	SKH-200	FKH-200				TKHD-200 SKHD-200
3	TGM-300	SGM-300	FGM-300	TKL-300	SKL-300	FKL-300	TGMD-300 SGMD-300 TKLD-300 SKLD-300
3	TGH-300	SGH-300	FGH-300				TGHD-300 SGHD-300
5	TBH-500	SBH-500	FBH-500	TGL-500	SGL-500	FGL-500	TBHD-500 SBHD-500 TGLD-500 SGLD-500
7.5	TBH-750	SBH-750					TBHD-750 SBHD-750
10		SCAH-1000		TBL-1000	SBL-1000		SCAHD-1000 SBLD-1000 TBLD-1000
15		SFAH-1500			SEAL-1500		SEALD-1500 SFAHD-1500
20					SCAL-2000		SCALD-2000
30					SFAJ-3000		SFAJD-3000

## WIRE ROPE



Rope Dia (mm) d	Mode Being Used	Construction	Specified Breaking Load (kg)
§ 8	TPM-100 FPM-100 TKH-200 SKH-200 FKH-200	6x37-A	34
	TKL-300 SKL-300 FKL-300 TGH-300 SGH-300 FGH-300		53.1
§ 10	TKM-200 SKM-200 FKM-200	IWRC 6xFi(29)-B	67.7
	TGL-500 SGL-500 FGL-500 TBH-500 SBH-500 FBH-500	IWRC 6xP.Fi(29)-H	84
§ 12	TGM-300 SGM-300 FGM-300	IWRC 6xFi(29)-B	97.7
§ 14	TBH-750 SBH-750	6x37-H	123
§ 16	TBL-1000 SBL-1000 SCAH-1000	6x37-H	161
§ 18	SFAH-1500 SFAJ-3000	IWRC 6xFi(29)-H	234
§ 20	SEAL-1500		289
	SCAL-2000	IWRC 6xP.Fi(29)-H	331

## HOOK

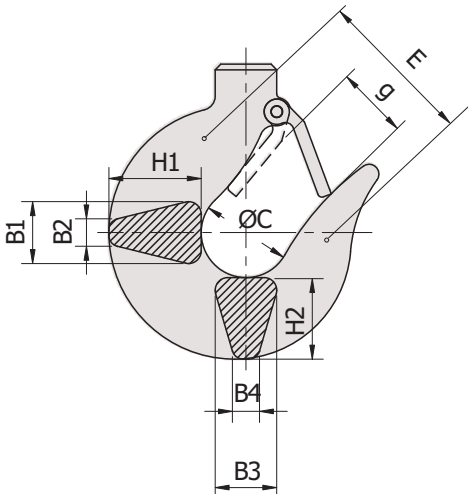

Mode	Capacity (ton)	Dimension (mm)									Tensile Stress (kg/mm <sup>2</sup> )	Hook Block Weight (kg)
		H1	B1	B2	H2	B3	B4	C	g	E		
T;FPM	1	33	23	9	29	23	9	40	27	55	70	10
T;F;SKM	2	45	31	10	41	31	10	45	33	70	70	30
T;F;SKH												
T;F;SGM	3(2.8)	57	38	12	52	38	12	60	42	100	70	40
T;F;SKL												50
T;F;SGH	5	75	48	16	68	48	16	75	56	105	70	50
T;F;SGL												60
T;F;SBH	7.5	85	61	22	77	61	22	85	62	140	70	90
T;SBL												150
SCAH	10	100	70	28	95	65	28	100	70	130	70	140
SEAL	15	120	85	32	110	83	32	120	82	167	70	220
SFAH												
SCAL	20	140	100	38	130	95	38	140	105	220	70	290
SFAJ	30	140	98	38	130	94	38	140	105	220	100	420



### POWER SUPPLY :

- ▲ Electric wire rope hoist suits majority of the 3-Phase power in different countries, available in 50Hz or 60Hz, voltage from 220V up to 600V.
- ▲ Dual-volt hoist subject to our confirmation.

### LIFTING HEIGHT :

- ▲ Standard lifting height : Please refer to specifications.
- ▲ Optional height available upon request.

### PUSH BUTTON SWITCH :

- ▲ 2-point type : up and down.
- ▲ 4-point type : up and down ; left and right (trolley).
- ▲ 6-point type : up and down ; left and right ; forward and reverse (end carrier)

# FEDERATION EUROPEENNE DE LA MANUTENTION

Load spectrum	Cubic mean value Definitions	Average operating time per day in hours							
		0.25-0.5	0.5-1	1-2	2-4	4-8	8-16	> 16	
1 (light)	$(k \leq 0.50)$ Mechanisms or parts thereof, usually subject to very small loads and in exceptional cases only to maximum loads.	0.25-0.5	0.5-1	1-2	2-4	4-8	8-16	> 16	
2 (medium)	$(0.50 < k \leq 0.63)$ Mechanisms or parts thereof, usually subject to small loads but rather often to maximum loads.	0.12-0.25	0.25-0.5	0.5-1	1-2	2-4	4-8	8-16	> 16
3 (heavy)	$(0.63 < k \leq 0.80)$ Mechanisms or parts thereof, usually subject to medium loads but frequently to maximum loads.	$\leq 0.12$	0.12-0.25	0.25-0.5	0.5-1	1-2	2-4	4-8	8-16
4 (very heavy)	$(0.80 < k \leq 1)$ Mechanisms or parts thereof, usually subject to maximum or almost to maximum loads.		$\leq 0.12$	0.12-0.25	0.25-0.5	0.5-1	1-2	2-4	4-8
Classification of Mechanisms FEM 9.511		1 Dm	1 Cm	1 Bm	1 Am	2 m	3 m	4 m	5 m

## ISO/FEM (9.511)

### Classification of mechanisms:

1 Dm	1 Cm	1 Bm	1 Am	2 m	3 m	4 m	5 m
M 1	M 2	M 3	M 4	M 5	M 6	M 7	M 8

### Class of operating time:

Class of operation time	Average operating time per day (in hours)	Calculated total operating time in hours
V0.06   T0	$\leq 0.12$	200
V0.12   T1	$\leq 0.25$	400
V0.25   T2	$\leq 0.5$	800
V0.5   T3	$\leq 1$	1600
V1   T4	$\leq 2$	3200
V2   T5	$\leq 4$	6300
V3   T6	$\leq 8$	12500
V4   T7	$\leq 16$	25000
V5   T8	$> 16$	50000

### Classification of mechanisms into groups:

Load spectrum	Cubic mean value	Class of operation time									
		V0.06	V0.12	V0.25	V0.5	V1	V2	V3	V4	V5	
		T0	T1	T2	T3	T4	T5	T6	T7	T8	
		Average operating time per day in hours									
		$\leq 0.12$	$\leq 0.25$	$\leq 0.5$	$\leq 1$	$\leq 2$	$\leq 4$	$\leq 8$	$\leq 16$	$> 16$	
1	L1	$k \leq 0.50$			1 Dm	1 Cm	1 Bm	1 Am	2 m	3 m	4 m
2	L2	$0.50 < k \leq 0.63$		1 Dm	1 Cm	1 Bm	1 Am	2 m	3 m	4 m	5 m
3	L3	$0.63 < k \leq 0.80$	1 Dm	1 Cm	1 Bm	1 Am	2 m	3 m	4 m	5 m	
4	L4	$0.80 < k \leq 1.00$	1 Cm	1 Bm	1 Am	2 m	3 m	4 m	5 m		

## OPERATION CYCLE

### Hoist with one speed

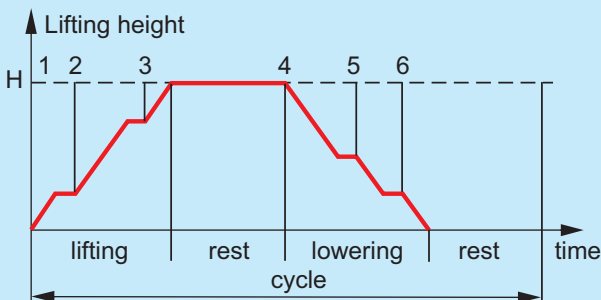

### Hoist with two speed

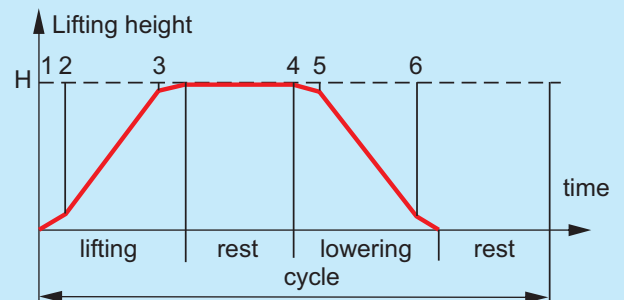



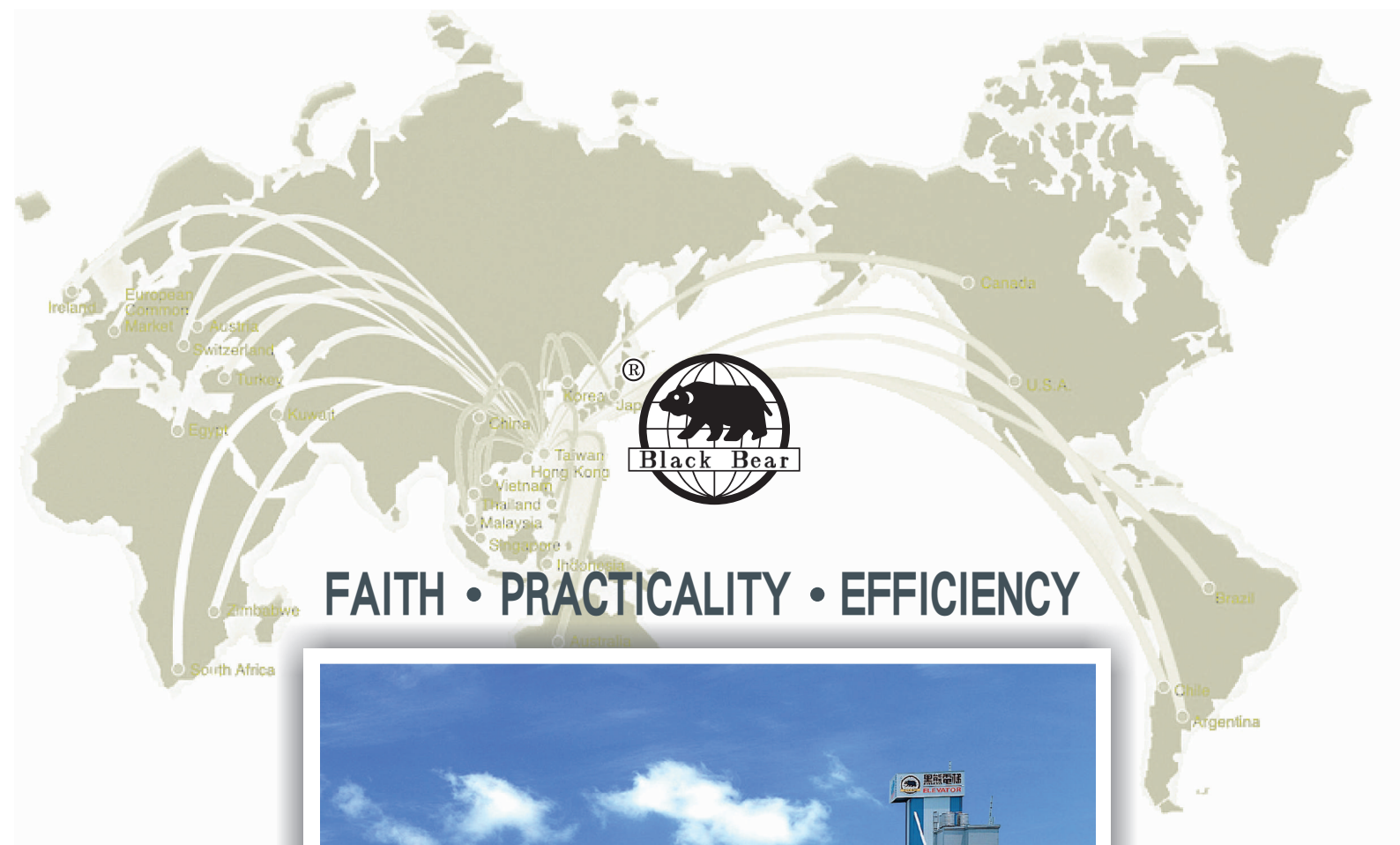

**FAITH • PRACTICALITY • EFFICIENCY**



## **CHENG DAY MACHINERY WORKS CO., LTD.**

No. 173, Wen Chiu Rd., Dajia Dist., Taichung City 437, Taiwan

Tel: +886-4-2688-1581 Fax: +886-4-2688-1509

Website: [www.chengday.com.tw](http://www.chengday.com.tw)

E-mail: [info@chengday.com.tw](mailto:info@chengday.com.tw)

- Revision of April, 2014 (Edition No.16) #950105
- No further notice while sizes and dimensions update; Quotations are based on practical dimensions.
- Due to the printing factors, the color of the products is subject to minor deviation from the physical objects.